



**Archaeological Monitoring at the Old
School Lodge, New Cross Street,
Margate, Kent
*September 2011***

SWAT. Archaeology
Swale and Thames Archaeological Survey Company
School Farm Oast, Graveney Road
Faversham, Kent
ME13 8UP
Tel: 01795 532548 or 07885 700 112
www.swatarchaeology.co.uk

Archaeological Monitoring at the Old School Lodge, New Cross Street, Margate, Kent

NGR: 635362 170935
Site Code OSL/WB/11



Report for
BHD Architects LLP

SWAT ARCHAEOLOGY

Swale and Thames Archaeological Survey Company
The Office, School Farm Oast, Graveney Road
Faversham, Kent ME13 8UP
Tel; 01795 532548 or 07885 700 112
info@swatarchaeology.co.uk www.swatarchaeology.co.uk

Contents

1.0 SUMMARY.....	4
2.0 INTRODUCTION.....	4
2.1 PLANNING BACKGROUND.....	4
3.0 SCHEDULE OF VISITS.....	5
4.0 AIMS AND OBJECTIVES.....	5
4.1 PROPOSED GROUNDWORKS.....	5
4.2 CONFIDENCE RATING.....	5
5.0 ARCHAEOLOGICAL & GEOLOGICAL BACKGROUND.....	5
6.0 METHODOLOGY.....	6
7.0 RESULTS.....	6
7.1 GENERAL.....	6
7.2 DEPOSIT MODEL.....	6
8.0 FINDS.....	6
9.0 DISCUSSION.....	7
10.0 CONCLUSION.....	7
11.0 ACKNOWLEDGMENTS.....	7
REFERENCES.....	8
APPENDIX 1 - .KCC HER Summary Form.....	8

Cover: Google aerial view of site.

Plate 1. General view of site

Plate 2. Photograph of site

Plate 3. Removal of building slab

List of Figures

Figure 1. OS plan of development site

Archaeological Monitoring at the Old School Lodge, New Cross Street, Margate, Kent

NGR: 635362 170935
Site Code OSL/WB/11

Date of report: 12/09/11



Plate 1. View of site

1.0 Summary

1.1. From 12th August 2011 to 17th August 2011 Swale and Thames Archaeological Survey Company (SWAT Archaeology) carried out an Archaeological Watching Brief on a proposed development at Old School Lodge, New Cross Street, Margate, Kent.

1.2. The works were carried out on behalf of BHD Architects, Oak House, London Road, Sevenoaks, Kent TN13 1AF.

1.3. An Archaeological Watch was kept during machine piling for new foundations, drain runs and service trenches. The archaeological work was undertaken in two phases.

Phase 1. Piling of new foundations from 12th August 2011

Phase 2. Drain and service trenches 15th-17th August 2011

1.4. The Archaeological Watching Brief was to watch for any archaeological below ground impact.

1.5. The Planning Application Number for the development is: TH/11/0055.

1.6. Although the archaeological potential was high the Archaeological Watching Brief revealed no buried archaeological features.

2.0 Introduction

2.1 Planning Background

Planning application TH/11/0055 for the demolition of buildings to build two new dwellings was submitted to the Local Planning Authority.

Kent County Council Heritage and Conservation (KCCHC), on behalf of the Local Planning Authority requested that an Archaeological Watching Brief be undertaken in order to record any archaeological remains uncovered during the development work. The following condition was attached to the planning consent:

(3.) No development shall take place until the applicant, or their agents or successors in title, has secured the implementation of a programme of archaeological watching brief in accordance with a written specification and timetable which has been submitted to and approved by the Local Planning Authority.

Reason: To ensure that features of archaeological interest are properly examined and recorded.

3.0 Schedule of Visits

An archaeologist attended the site and monitored the excavation works between the following dates: 12th August to 17th August 2011.

4.0 Aims and Objectives

4.1. The reason for the monitoring and recording, as specified by Kent County Council were to:

3.1 The objectives of the archaeological watching brief are to contribute to knowledge of the Isle of Thanet through the recording of any archaeological remains exposed as a result of excavations in connection with the ground works. Particular attention will be paid to the character, height below ground level, condition, date and significance of the deposits.

4.2. The ground works include the demolition of the existing structure, piling for new foundations and a drain and services trench.

4.3. A full programme of proposed works by the contractor were made available to SWAT Archaeology before the on-site monitoring took place.

4.4. Confidence Rating

No factors hindered the recognition of archaeological and deposits during the monitoring and recording exercise.

5.0 Archaeological and Geological Background

5.1. The underlying geology at the site according to the British Geological Survey map is Upper Chalk with a capping of Brickearth to the north of the site.

5.2. The application site is located is situated in the historic core of Margate and located on the north side of New Street, to the rear of Old Schools Lodge which fronts on to New Cross Street. It is north -west of Cecil Square (see front cover).

5.3. The site lies within an Area of Archaeological Potential associated with archaeological remains presently recorded in the HER.

Two ditches of unknown date (**TR 37 SE 53**) were excavated by John Vilette in College Square.

Possible sites of early 18th century malting and brew house (**TR 37 SE 268**) were identified at Reeves Brewery in Hawley Street.

6.0 Methodology

6.1. The Watching Brief was conducted in accordance with the specification compiled by Kent County Council Heritage and Conservation and it also complied with the Institute of Field Archaeologists' Standards and Guidance for Archaeological Watching Briefs (Ifa: 2008).

6.2. The works comprised the observation of all groundworks, including the inspection of subsoil and natural deposits for archaeological features and finds.

6.3. The Watching Brief was carried out in several phases according to the needs of the building contractors from August 12th to 17th August 2011.

6.4. Excavation of the overlying ground, service, and drainage trench was carried out using a 360° mechanical excavator fitted with a toothless ditching bucket.

6.5. All excavation was carried out under the constant supervision of an experienced archaeologist.

6.6. Where possible the areas of excavation were subsequently hand-cleaned with the intention of revealing features in plan and section.

6.7. If found archaeological features under threat were to be excavated to enable sufficient information about form, development date and stratigraphic relationships to be recorded without prejudice to more extensive investigations, should these prove to be necessary.

6.8. The archaeological watching brief was carried out in accordance with current IfA Standards and Guidance, (IfA: 2008), and methodology discussed with Archaeological Officers, KCC.

7.0 Results

7.1 General

The site, formerly comprising a derelict building and yard was excavated in two phases (Plate 1). The subsoil encountered across the site was a constant Upper Chalk overlaid by modern building rubble cut by the occasional drain with no archaeological features revealed.

8.0 Finds

No buried archaeological features were located in the Archaeological Monitoring phase and no finds were retrieved.

9.0 Discussion

The development is in an area of medium potential with the medieval core of Margate adjacent and Prehistoric and Medieval activity nearby. The archaeological team were somewhat disappointed that no archaeology was revealed.

10.0 Conclusion

The Archaeological Monitoring has fulfilled the primary aims and objectives of the Specification. As far as it is known no buried archaeological features have been affected as a result of the development.

11.0 Acknowledgments

SWAT Archaeology would like to thank BHD Architects for commissioning the project.

A handwritten signature in black ink that reads "Paul Wilkinson". The signature is written in a cursive, slightly slanted style. The name "Paul" is on the first line and "Wilkinson" is on the second line, with the letters overlapping.

Dr Paul Wilkinson MIfA. 12th September 2011

References

HER data (KCC 2011)

IFA (1999 & 2008) Standards and Guidance for Archaeological Watching Briefs

Specification for a Programme of Archaeological Watching Brief at Old School Lodge, New Cross Street in Margate (Kent County Council 2011).

Appendix 1- Kent County Council HER Summary Form

Site Name: Development site at Old School Lodge, New Cross Street, Margate, Kent

SWAT Site Code: OSL/WB/11

Site Address: As above

Summary:

Swale and Thames Survey Company (SWAT) carried out Archaeological Monitoring on a development at Old School Lodge, New Street in Margate. The site has planning permission for the building of two houses (TH/11/0055) whereby Kent County Council Heritage and Conservation (KCCHC) requested that Archaeological Monitoring be undertaken to determine the possible impact of the development on any archaeological remains.

The work was carried out in accordance with the requirements set out within an Archaeological Specification (KCC 2011) and in discussion with the Archaeological Officer, Kent County Council. The Archaeological Monitoring consisted of numerous site visits which encountered no buried archaeological features or artefacts.

District/Unitary: Margate **Parish:** Margate

Period(s):

NGR (centre of site to eight figures) NGR 635362 170935

Type of Archaeological work: Archaeological Monitoring

Date of recording: 12th August to 17th August 2011

Unit undertaking recording: Swale and Thames Survey Company (SWAT. Archaeology)

Geology: Underlying geology is Upper Chalk

Title and author of accompanying report: Wilkinson P. (2011) Archaeological Monitoring at The Old School Lodge, New Cross Street, Margate, Kent

Summary of fieldwork results (begin with earliest period first, add NGRs where appropriate)

See above

Location of archive/finds: SWAT. Archaeology, Graveney Rd, Faversham, Kent. ME13 8UP

Contact at Unit: Paul Wilkinson

Date: 12th September 2011



Plate 2. General view of site



Plate 3. Removal of previous building slab and extent and depth of excavation

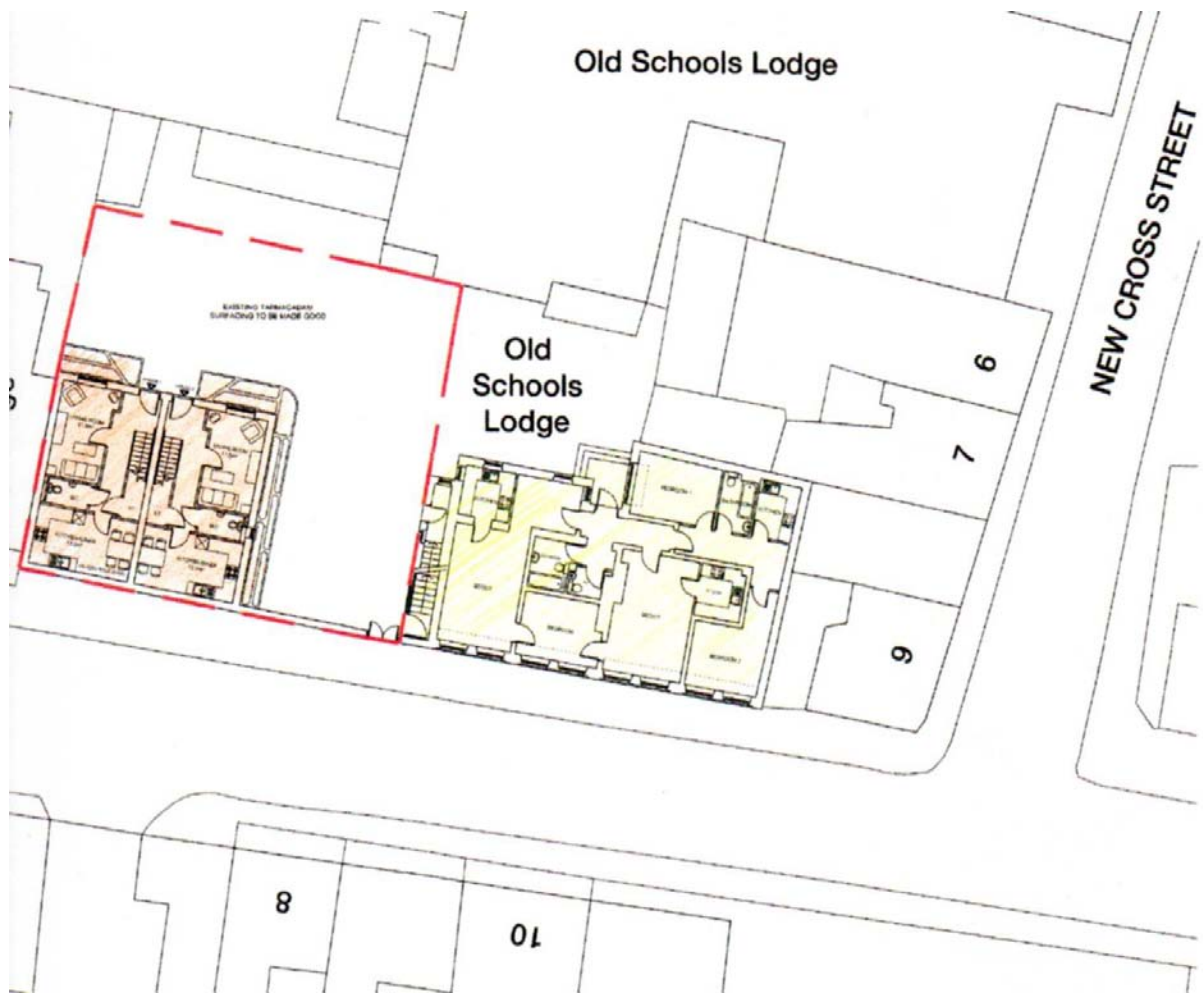

Fig. 1 Location of site. Orange tint is new build of two houses, yellow tint conversion of existing building. Scale 1:200 at A3