



**Archaeological Evaluation at
67 High Street, Bridge, Canterbury,
Kent
*May 2011***

SWAT. Archaeology
Swale and Thames Archaeological Survey Company
School Farm Oast, Graveney Road
Faversham, Kent
ME13 8UP
Tel: 01795 532548 or 07885 700 112
www.swatarchaeology.co.uk

POST-EXCAVATION ASSESSMENT OF THE ARCHAEOLOGICAL EVALUATION AND ASSESSMENT OF LAND AT 67 HIGH STREET, BRIDGE, CANTERBURY, KENT CT4 5LA.

Canterbury City Council Local Planning Authority

Planning Application: APP/J2210/E/10/2137376 & APP/J2210/A/10/2137378

Condition 2. Erection of a house extension.

1 Introduction and Summary

Dr and Mrs Mills of 67 High Street, Bridge, Canterbury, Kent CT4 5LA are currently making preparations for the development of 67 High Street at Bridge, Canterbury, Kent. The proposed development is to comprise the erection of an extension with additional bedrooms. A planning application for the proposed development (APP/J2210/E/10/2137376 & APP/J2210/A/10/2137378) has been submitted to Canterbury City Council and subsequently granted consent on appeal with an attached condition (2) stating that:

No development shall take place until the applicant or the developer, or their successor(s) in title has secured, firstly, the implementation of an archaeological evaluation of the site, to be undertaken for the purpose of determining the presence or absence of any buried archaeological features and deposits and to assess the importance of the same, and secondly, any mitigation measures, including further archaeological work that may be required as a result of the evaluation, to safeguard the preservation of archaeological remains. All archaeological works to be carried out in accordance with written programmes and schemes of work that have been submitted to and approved by the local planning authority. REASON: To ensure a proper record of matters of archaeological interest.

In mitigation of the potential impact that the development may have on the buried archaeological resource and in accordance with the provisions of Planning Policy Statement 5 (2010) and condition 2 of the planning consent, SWAT. Archaeology carried out a programme of archaeological evaluation of the proposed development site. The archaeological works were monitored by the Canterbury City Council Archaeological Officer.

The evaluation works were undertaken to assess the potential impact of the proposed development on any buried archaeological features and deposits that may be present within the proposed development area.

2 Archaeological Potential and Objectives

Bridge is an historic village straddling the A2, formally the Roman road (Watling Street) from Richborough and Dover to London. As yet no archaeological remains have been found in Bridge although the surrounding district is rich in Anglo-Saxon activity. It is thought the name 'Bridge' – as in Bruges- may suggest a Roman bridge straddling the river crossing of the Nailbourne. This Roman bridge may be located in the vicinity of 67 High Street, the proposed development site.

Further details of previous discoveries and investigations within the immediate and wider area may be found in the Canterbury & District Historic Environment Record. These records have been consulted.

The principle objective of the archaeological evaluation was to establish the presence or absence of any elements of the archaeological resource across the area of the proposed development site.

To ascertain the extent, depth below ground surface, depth of deposit if possible, character, date and quality of any such archaeological remains by limited sample excavation.

To determine the state of preservation and importance of the archaeological resource if present.

The opportunity was also taken during the course of the evaluation to place and assess any archaeology revealed within the context of other recent archaeological investigations in the immediate area and within the setting of the local landscape and topography.

3 Methodology

Archaeological evaluation was undertaken by hand of two evaluation test pits located across the proposed development site, one on the footprint of the proposed rainwater soak-away and the other where the foundation trench to the proposed extension will be located. The total length of trenches cut was 4m representing a 2% sample of the proposed development site.

A single context recording system was used to record the deposits. A full list is presented in Appendix 1. Layers and fills are recorded (**001**). The cut of the feature is shown [**001**]. Context numbers were assigned to all deposits for recording purposes; these are used in the report.

4 Monitoring

Curatorial monitoring was carried out by Richard Cross Archaeological Advisor for Canterbury City Council during the course of the evaluation.

5 Results

Test Pit 1.

Test Pit 1 was located where the proposed rainwater soak-away was to be dug. The turf and topsoil (101) at about 22cm thick overlaid made-up ground (102) about 11cm thick and of firm mid grey-brown silty clay with very frequent sub-angular flint pebbles and occasional sub-angular flint cobbles with occasional CBM and pottery fragments. Pottery found in this layer (102) comprises 12 sherds (190gms) with a likely date of 1800-1850AD.

Under the layer of (102) was a mixed layer of a probable buried soil layer (103) about

15cm thick. The soil was a firm, dark grey-brown silt with occasional chalk fragments and occasional small sub-rounded flint pebbles. There was a very diffuse boundary between (103) and the layer immediately below (106). Pottery found in this layer (103) and (106) consisted of 21 sherds (361gms) and the pottery specialist (Appendix 1) has indicated that the field observation is correct and both (103) and (106) are well mixed with Roman, medieval and post-medieval retrieved from these contexts. A likely date of (103) being c.1750-1800AD and (106) c.1500-1550AD or slightly earlier.

In the south corner of Test Pit 1 and under (106) a chalk floor or foundation of crushed chalk (107) was revealed and about 10cm thick running diagonally across the Test Pit from north-west to south-east. Four pottery sherds were retrieved within the matrix of the feature (107) date from c.1075 to 1550 AD with the pottery specialist suggesting a date for the feature (106) of c.1500-1550AD.

Immediately below the chalk surface (107) was a layer of compacted to loose mid grey-brown clay silt (110) with frequent sub-rounded (water rolled) medium flint cobbles and frequent sub-rounded medium to large flint pebbles and occasional grit. No pottery was retrieved from this layer and the excavator postulates that the layer is alluvial and probably resulting from flooding before being built on in the medieval period. This layer (110) seals the layer below which is Roman.

The layer below (110) is about 18cm thick and is a firm grey-black clay silt with numerous flecks of charcoal. This layer (108) is not a fill or deposit as the layers above it but a buried soil horizon dated by 13 sherds found in secure contexts to c.200-259AD.

This layer (108) is about 70cm (700mm) from turf ground level.

Below the Roman occupation layer and to the full extent of the test pit depth of 1m was firm mid-grey clay silt (109) with inclusions of gravel, sub-rounded flint pebbles and devoid of any cultural material. However, this alluvial layer (109) may cover earlier archaeology.

Test Pit 2

Test Pit 2 was located adjacent to the proposed extension and again was a one metre square test pit dug by hand. The topsoil (201) about 20cm thick was a firm mid black-brown silty clay with chalk pieces, CBM fragments, and charcoal flecks and extended across the test pit. 5 sherds (75gms) of pottery were retrieved with a date of c.1850-1900 plus. Below (201) was a buried soil horizon some 13cm thick and firm and mid grey-brown clay silt (202) with frequent chalk flecks, CBM flecks and Charcoal pieces. Again this layer extends across the test pit. No pottery sherds were retrieved from (202). Below (202) a layer of firm mid brown silty clay (203) with frequent chalk fragments and occasional sub-angular flint pebbles and about 8cm thick extended part way over the test trench ((Sections 5, 7). No pottery was retrieved from this layer (203). A dump of buried soil was recognised on the north east section face (204)-again with no pottery inclusions.

Another dump of building rubble was seen on the eastern side of the test pit (205), about 11cm thick and identified by four sherds (19gms) of pottery as probably dating from c.1750-1800AD. Under (205) and extending the full width of the test pit was a firm mid grey-brown clay silty layer (206), about 16cm thick and with rare chalk

fragments, oyster shells, charcoal and CBM. Pottery sherds (137gms) have a date range from c.1150 to 1650AD with a probable date of c.1425-1475AD. Below (206) was a dumped layer of mid brown clay silt (207) about 7cm thick with no pottery inclusions.

Under (207) is a 19cm layer of compacted mid brown-grey clay silt with sub-rounded flint pebbles and cobbles (208). This layer extends across the test pit and is thought by the excavator to be virtually devoid of cultural material and could be a post-Roman and pre-medieval layer of alluvial flood deposit and probably the same as context (110) in Test Pit 1. However, one pottery sherd was retrieved from (208), an Early Roman North Kent fine grey ware jar rim, chipped and moderately worn with a production date of c.75-125/150AD which reinforces the hypothesis.

Below (208) was a firm, greasy of very dark grey-black silty clay some 22cm thick (209). The layer had occasional sub-angular pebbles, very frequent charcoal flakes and rare charcoal pieces. The strata of dark grey organic soil (209) extended across the test pit. Over 33 sherds (243gms) of Roman pottery dating from c.200-250AD were recovered.

Overall 25-30 small or large Roman flagons were recovered from this context (209) and (210).

Context (209) dated by Roman pottery to about c.200-250AD is 55cm below the turf ground level in Test Pit 2.

The layer below (209) is a mix of cress, and mid grey silty clay mixed with natural iron nodules. The layer is about 11cm thick and 22 sherds of Roman pottery were recovered (210) dating to c.200-250AD.

Below (210) a sondage was cut in the west corner through a hard gravel base with frequent nodules of ironstone making the strata fuse together into a hard surface. No pottery or CBM were recovered. It is thought by the excavator that this was the surface of a Roman road.

Finds

128 pottery sherds (1kg.461gms) were recovered from the two Test Pits. Five 10ltr soil samples were also retrieved for analysis.

Discussion

The Test Pit evaluation carried out on land at 67 High Street, Bridge revealed medieval and Roman occupation with medieval chalk surfaces revealed in Test Pit 1 and Roman occupation levels and the surface of a Roman road in Test Pit 2.

Conclusion

The archaeological evaluation has been successful in fulfilling the primary aims and objectives of the Specification. Important Roman archaeology has been identified in Test Pit 1 at 70cm below the turf horizon at 24.54mOD and at 55cm below the turf horizon in Test Pit 2 at 24.63mOD.

This evaluation has therefore assessed the archaeological potential of land intended for development. The results from this work will be used to aid and inform the Archaeological Officer (CCC) of any further archaeological mitigation measures that may be necessary in connection with the development proposals.

Acknowledgements

SWAT would like to thank Mervyn Gulvin Architects for commissioning the project. Thanks also to the Canterbury City Council Archaeological Officer for his advice and assistance. Marcus Headifen and Paul Wilkinson carried out the archaeological fieldwork. Pottery report by Nigel MacPherson-Grant and GPS survey by 'Digitise This'. The project was managed by and report written by Paul Wilkinson

Copies of all reports compiled as a result of the excavation and post-excavation archaeological works will be submitted to Mervyn Gulvin Architects. In addition one PDFcopy of each report to the Canterbury City Council Archaeological Officer and one copy of each report to the HER Officer, Heritage Conservation, Strategic Planning, Kent County Council, Invicta House, County Hall, Maidstone ME14 1XX for inclusion on the Kent County Sites & Monuments Record.

In undertaking the work the archaeological contractor abided by the: *Code of conduct* and the: *Code of approved practice for the regulation of contractual arrangements in field archaeology* of the Institute of Field Archaeologists.

*Compiled by: SWAT.Archaeology- Dr Paul Wilkinson MifA.
21/05/2011*

Appendix 1.

THE DATING AND ASSESSMENT OF THE CERAMIC ASSEMBLAGE FROM :

BRIDGE EVALUATION 2011 (BRI-EV-11)

A. Primary quantification : 128 sherds (weight : 1kg.461gms)

B. Period codes employed :

ER	= Early Roman
ER-MR	= Early-Mid Roman transition
MR	= Mid Roman
EM	= Early Medieval
EM-M	= Early Medieval transition
M	= Medieval

M-LM	= Medieval-Late Medieval transition
LM	= Late Medieval
PM	= Post-Medieval
LPM	= Late Post-Medieval

C. Context dating :

C.1 : Unstratified contexts :

Context: 102 - 12 sherds (weight : 190gms)

3 sherds PM red earthenware (c.1625/1650-1700 AD probably)

1 sherd PM red earthenware (c.1675-1725/1750 AD emphasis probably)

1 sherd PM Creamware (c.1740-1780 AD)

1 sherd PM red 'basaltes' ware (c.1765-1800 AD)

2 sherds LPM red earthenware (c.1750-1800/1825 AD emphasis)

3 sherds LPM Later Creamware (1 blue transfer-printed, c.1775-1825 AD)

1 sherd LPM Pearl Ware (c.1780-1825 AD)

Comment : Small, mostly moderate-sized, one large, sherd. C17 AD material more worn – 1 lightly burnt. LPM material mostly fairly fresh – but one Later Creamware chipped and battered, and 1 burnt (transfer-printed).

Likely date : Probably residual – if not c.1800-1850 AD

C.2 : Excavated contexts :

Context: 101 - 12 sherds (weight : 73gms)

1 sherd PM Staffordshire-type white stoneware (c.1725-1780 AD)

1 PM-LPM claypipe stem (broadly C18-C19 AD)

4 sherds LPM Later Creamware (c.1775-1825 AD)

1 sherd LPM English porcelain (c.1775-1825 AD emphasis probably)

1 sherd LPM ?soft paste porcelain (gilded, c.1775-1825/1850 AD emphasis probably)

1 sherd LPM ? Staffs-type white earthenware (purple-blue transfer, c.1825-1850/1875 AD; **possibly =**

Context 201)

1 sherd LPM English porcelain (gilded, c.1850-1900 AD probable emphasis)

1 sherd LPM white earthenware (blue band, c.1850-1900 AD probable emphasis)

1 sherd LPM-Modern red earthenware – flower-pot type (c.1875-EC20 AD probably; **?intrusive)**

Comment : Small earlier elements - Staffordshire stoneware tea-pot fragment and Later Creamware sherds fairly battered and residual in-context. Remainder larger and near-fresh.

Likely date : Probably residual – if not c.1850-1900 AD-plus

Context: 103/106 - 21 sherds (weight : 361gms)

2 sherds ER-MR Canterbury red sandy ware (c.125-150/175 AD)

2 sherds ER-MR Canterbury red sandy ware (c.125/150-175 AD emphasis)

1 sherd MR Canterbury white-cream sandy ware (hard-fired, flagon, c.150-175/200 AD)

1 sherd MR Canterbury pink-buff sandy ware (flagon, c.150-175/200 AD probably)

1 sherd MR pink-buff sandy ware (flagon, c.150-175/200 AD)

2 sherds LM Canterbury Tyler Hill sandy ware (c.1425-1450/1475 AD probably)

1 sherd LM German Siegburg stoneware (c.1450-1475/1500 AD emphasis probably)

1 sherd LM Canterbury Tyler Hill sandy ware (c.1475-1500/1525 AD)

1 sherd PM North Dutch fine red earthenware (c.1575/1600-1650 AD emphasis probably; **burnt**)

1 sherd PM ?Wealden-type buff sandy earthenware (c.1575/1600-1650 AD probably)

1 sherd PM red earthenware (c.1625/1650-1700 AD emphasis)

2 sherds PM red earthenware (c.1650/1675-1725 AD emphasis)

1 sherd PM English tin-glazed earthenware (blue-tinted, c.1675-1750/1770 AD emphasis)

3 sherds PM red earthenware (c.1675/1700-1750 AD emphasis)

Comment : A note accompanying this context-assemblage indicates that two contexts – 103 and 106 may be mixed – 103 being 'Post-Medieval' and 106 being 'Medieval' (site-labelled as such because the Late Medieval and Roman coarsewares are all sandy and superficially could look post-Roman).

Treated separately – **103** contained mostly small-medium sized sherds, variably worn (irrespective of

chronological position) but including one tin-glazed bodysherd with flaking glaze; **106** contained Roman and, presumably, the Late Medieval sherds (except that they could have been residual amongst PM material) – all sandy wares except for the large Siegburg stoneware mug base. The latter is near-fresh but contemporary Canterbury wares variably worn. Roman material is small-moderate-sized and mostly only moderately worn.

Likely date : 103 = possibly c.1750-1800 AD; 106 = c.1500-1550 AD or slightly earlier (if Roman = c.200-250 AD)

Context: 107, chalk floor - 4 sherds (weight : 42gms)

1 sherd EM Canterbury-type sandy ware (c.1075/1100-1150 AD)

1 sherd M-LM Canterbury Tyler Hill sandy ware (c.1350/1375-1425 AD emphasis probably)

1 sherd LM Canterbury Tyler Hill sandy ware (c.1475-1500/1525 AD)

1 sherd LM ?Wealden-type buff sandy ware (c.1475-1525/1550 AD)

Comment : The EM sherd is small and fairly worn, all the other elements are larger and mostly only slightly worn – the Wealden-type sherd is near-fresh.

Likely date : Possibly c.1500-1550 AD

Context: 108 - 13 sherds (weight : 136gms)

1 sherd ER Canterbury pink-buff sandy ware (flagon, c.100/125-150 AD probably)

1 sherd ER-MR Canterbury white-cream sandy ware (flagon, 125-150/175 AD)

1 sherd ER-MR pink-buff sandy ware (c.125-150/175 AD probably)

4 sherds ER-MR Canterbury red sandy ware (c.125/150-175 AD)

1 sherd MR Canterbury red sandy ware (scorched, c.150-175 AD)

1 sherd MR Native Coarse Ware (c.150-175/200 AD emphasis)

2 sherds MR Canterbury pink-buff sandy ware (flagons, c.150-175/200 AD)

1 sherd MR pink-buff sandy ware (flagon, c.150-175/200 AD)

1 sherd M Canterbury Tyler Hill sandy ware (glazed pan base, c.1200-1225/1250 AD; **intrusive**)

Comment : A few small, mostly medium-sized sherds, rim and body, flagons and jars, principally hard-fired oxidized, all fairly worn, earliest more so, Native Coarse Ware bodysherd fairly heavily worn – and dated by firing trend but could be slightly earlier or later. Medieval sherd is small, worn and internally sooted

1 flagon (white-cream), 1 lid and 2 jar rims

Likely date : c.200-250 AD probably

Context: 201 - 5 sherds (weight : 75gms)

1 sherd ER-MR Canterbury pink-buff sandy ware (flagon, c.125/150-175 AD)

1 sherd MR North Kent fine oxidised ware (c.175/200-250 AD probably)

1 sherd PM German Frechen stoneware (c.1625/1650-1750 AD emphasis probably)

1 sherd LPM ? Staffs-type white earthenware (purple-blue transfer, c.1825-1850/1875 AD; **possibly =**

Context 101)

1 sherd LPM 'Yellow Ware' (c.1825/1850-1900 AD)

Comment : Roman sherds include 1 large only moderately worn flagon sherd – these are residual in-context. PM-LPM sherds all moderate-sized and near-fresh.

Likely date : Probably residual – if not c.1850-1900 AD-plus

Context: 205 - 4 sherds (weight : 19gms)

1 sherd PM red earthenware (c.1650/1675-1725 AD)

1 sherd PM red earthenware (c.1675/1700-1750 AD probably)

2 PM claypipe stems (C17-C18 AD)

Comment : Small>fairly small bodysherds, earliest fairly worn, latest fresh, claypipe stems undamaged.

Likely date : If not residual – possibly c.1750-1800 AD or slightly earlier.

Context: 206 - 11 sherds (weight : 137gms)

1 sherd EM moderately sandy shell-tempered ware (c.1150-1175/1200 AD emphasis)

1 sherd EM-M moderately sandy shell-tempered ware (c.1175-1200/1225 AD)

2 sherds M Canterbury Tyler Hill sandy ware (c.1250-1325/1350 AD)

1 sherd LM Canterbury Tyler Hill sandy ware (c.1375/1400-1425 AD probably)

2 sherds LM Canterbury Tyler Hill sandy ware (c.1425-1450/1475 AD emphasis)

1 sherd LM Canterbury Tyler Hill transitional moderately sandy ware (c.1475-1500/1525 AD)

1 sherd PM brown earthenware (c.1575-1625/1650 AD probably)

1 sherd PM Surrey-Hampshire Border Ware (yellow-glazed, c.1600-1650/1675 AD)
1 sherd PM red earthenware (c.1600/1625-1650 AD)
Comment : The 4 pre-C15 AD elements are small and moderately worn – the earliest (EM) more so.
The Late Medieval sherds are moderate>fairly large-sized – most slightly chipped or lightly worn. The PM sherds are fairly small – noticeably more than the LM - but most near-fresh.
Likely date : If not intrusive – c.1650-1700 AD or slightly later

Context: 208 - 1 sherd (weight : 8gms)
1 sherd ER North Kent fine grey ware (c.75-125/150 AD)
Comment : Jar rim, moderate-sized, chipped and moderately worn.
Likely date : Uncertain – possibly residual - if not in a post-Roman context, in a Mid Roman one.

Context: 209 - 33 sherds (weight : 243gms)
2 sherds ER Southern Gaulish samian ware (La Graufesenque, Flavian, Dr.33 cups, 75-110 AD)
1 sherd ER Kent/SE England white-cream fine ware (flagon, c.75-125/150 AD probably)
1 sherd ER pink-buff sparse sandy ware (flagon, c.75-125/150 AD probable emphasis)
1 sherd ER pink-buff fine sandy ware (flagon, c.75/100-150 AD)
1 sherd ER Romanising native grog-tempered ware (c.75/100-150 AD)
8 sherds ER-MR Canterbury pink-buff sandy ware (flagons, c.125/150-175 AD; **2 scraps same vessel**)
2 sherds ER-MR pink-buff fine sandy ware (flagons – 1 white-slipped, c.125/150-175 AD)
2 sherds ER-MR Canterbury red sandy ware (c.125/150-175 AD)
1 sherd ER-MR Canterbury grey sandy ware (c.125/150-175 AD)
1 sherd ER-MR grog-tempered Native Coarse Ware (c.125/150-175 AD; = **Context 210**)
1 sherd MR Canterbury grey sandy ware (c.150-175 AD emphasis)
1 sherd MR Canterbury white-cream sandy ware (flagon, c.150-175/200 AD)
5 sherds MR Canterbury pink-buff sandy ware (flagons, c.150-175/200 AD)
1 sherd MR grog-tempered Native Coarse Ware (c.150-200/225 AD emphasis probably)
1 sherd MR BB2 sandy ware (c.150-200/250 AD, amalgam Monaghan 1987 Types 5C4/5D4)
1 sherd MR fine sandy ware (hard-fired, c.175/200-250 AD **probably**)
Comment : Small>mostly medium-sized sherds but also some large, earliest mostly small and generally more worn. Principally flagon bodysherds and only a few coarsewares – assemblage dominated by pink-buff sandy wares.
2 samian cup, 1 BB2-type bowl, rims
Likely date : c.200-250 AD probably

Context: 210 - 22 sherds (weight : 177gms)
1 sherd ER pink-buff fine sandy ware (?beaker/flagon, c.75-125/150 AD probably)
1 sherd ER ? Gallo-Belgic/SE.English pink-buff ware (c.75-125/150 AD, possibly Rigby 1995 Type WW8 fabric)
1 sherd ER North Kent fine grey ware (carinated beaker, c.75/100-125 AD, cf.Monaghan 1987 Type 2G)
2 sherds ER North Kent fine grey ware (S-profiled bowl, c.75/100-150 AD probably, cf.Monaghan 1987 Type 4A4.4)
1 sherd ER North Kent fine grey ware (globular beaker, c.100-125/150 AD emphasis, cf.Monaghan 1987 Type 2I1.2)
2 sherds ER-MR Canterbury pink-buff sandy ware (platter, 100/125-150 AD, cf.Monaghan 1987 Type 7A2)
1 sherd ER-MR Canterbury red sandy ware (c.125/150-175 AD)
5 sherds ER-MR Canterbury pink-buff sandy ware (c.125/150-175 AD; **2 same vessel**)
1 sherd ER-MR Canterbury white-cream sandy ware (flagon, c.125/150-175 AD)
1 sherd ER-MR grog-tempered Native Coarse Ware (c.125/150-175 AD; = **Context 209**)
1 sherd ER-MR pink-buff fine sandy ware (flagon, c.125/150-200 AD)
1 sherd MR Canterbury red sandy ware (scorched, c.150-175 AD)
6 sherds MR Canterbury pink-buff sandy ware (flagons, c.150-175/200 AD; **2 same vessel**)
1 sherd MR Canterbury white-cream sandy ware (flagon, c.150-175/200 AD)
2 sherds MR pink-buff sandy ware (flagon, c.150-175/200 AD)
Comment : Small>medium-sized sherds, body and rim, variable wear-pattern but only the earliest entry is fairly heavily worn, remainder moderately or only slightly. Assemblage includes a few North Kent fine grey ware beaker/jar sherds and a few kitchen coarsewares but majority are again flagon sherds. Assemblage dominated again by pink-buff sandy wares.

1 S-profiled bowl rim, 1 platter part-profile.

Likely date : c.200-250 AD

D. Assessment :

Overall, the recovered sherds provide the following period frequencies and implications :

PERIODS	SHERDS	IMPLICATIONS
MODERN	1	As below
LPM	18	As below
PM	24	Continuing, localised increased intensity from c.1625 AD
LM	10	As below, localised slight 15C AD increase
M-LM	1	As below
M	3	As below
EM-M	1	Continuing - localised low intensity
EM	2	Occupation from c.1100 AD probably
LS	-	-
MS	-	-
ES	-	-
LR	-	-
MR	29	? ceased between c.200-250 AD or slightly earlier
ER-MR	36	Continuing, peaking c.125-175 AD
ER	14	Occupation from c.75 AD, or slightly earlier
B/ER	-	-
LIA	-	-
MIA-LIA	-	-
MIA	-	-
EIA-MIA	-	-
EIA	-	-
LBA	-	-
MBA-LBA	-	-
MBA	-	-
EBA	-	-
LN	-	-
MN	-	-
EN	-	-

Indeterminate :

Two main periods of occupation appear to be represented :

Early-Mid Roman – c.75-250 AD :

Pottery of this general date was recorded from *Contexts 103/106, 108, 201, 208-210*. Of these – and despite one almost certainly small thirteenth century sherd intrusive into 209 -the material from *Contexts 108, 209* and *210* should all stem from basically un-contaminated Roman levels. *Context 208* may also belong with the latter but the chipped and rather worn condition of its single Early Roman sherd makes it uncertain whether it is contemporary or residual.

The contents of *108, 209-210* epitomise the overall recovered Roman assemblage – no pottery obviously prior to c.75 AD, a modest amount of later first to earlier second century material followed by increased quantities of mid and late second century material. Amongst the earlier material are fragments from 2-3 of North Kent fine grey ware tableware beakers – 1 globular and rouletted, 1 carinated - and also 2 samian Dr.33 cups. For the later material, the spread on the analysis table visually represents a remarkably uniform assemblage - dominated by Canterbury sandy ware products, dominated by sherds from flagons with their pink-buff, pale orange and a few white-cream firing colours, the reds of a number of coarseware jars and – for the specifically Mid Roman element – hard-fired sherds with fused or partially-fused fabrics. There are relatively few kitchen wares – a few grog-tempered Native Coarse Ware jars and a few Canterbury and other sandy ware jars, and 1 North Kent BB2 bowl profile with acute-trellis decoration. Overall between 25-30 small or large flagons appear to

be represented. This visual and vessel-class disparity, compared with the few associated kitchen wares is very noticeable. Since the present site may be very near to the former Roman road between Dover and Canterbury – and near to its crossing of the present Nailbourne stream - does raise the issue of whether this material represents accumulations from wayside hostelry breakages. Or, because the condition of the mid and later second century elements from all context-assemblages is only moderately worn, whether much of it – or at least its later elements - stems from a same-time clearance-deposit associated with such an establishment or possibly a shop.

The dating of this assemblage is principally determined by the high quantity of Canterbury products. One of these, from *Context 108* - is an oxidised everted-rim jar with a crisp very hard-fired fabric. The late phase of this industry – before its cessation around 175 AD – is typified by the occurrence of hard-fired vessels. This particular example, is so hard-fired that it is most unlikely that it pre-dates c.150 AD and should be late within the span c.150-175 AD. A number of the associated flagon sherds also have hard semi-fused fabrics however, with these, the dating may need to be extended since there is a little evidence indicating that the production of flagons at Canterbury may have continued until the end of the century (*pers.comm.* Malcolm Lyne). The suggested **c.200-250 AD** dating for this final, recovered, phase of Roman activity, takes this aspect into account and includes at least a few years use post-c.190/200 AD – but it is possible that this phase should be dated earlier - to between c.175-200 AD.

Early Medieval-Late Post-Medieval – c.1075-1900 AD-plus

The recovered post-Roman sherd evidence indicates continuous occupation of differing intensity, either on-site or in the immediate neighbourhood, from the Early Medieval period right through into the twentieth century. There is nothing particularly remarkable for most of this assemblage – a few purely local Canterbury or eastern Kentish shelly kitchen wares for the early part of the period – from around 1100 AD through to the late fifteenth or early sixteenth century. These include an earlier thirteenth century internally-glazed ‘non-stick’ frying pan, cooking-pots and one later fourteenth century rounded jug fragment. However, a little unexpectedly, *Context 103/106* produced a large base and lower-body sherd from an utterly typical example of a later fifteenth century German Siegburg stoneware small drinking jug (**Figs.1-2** and Macpherson-Grant 1995, Fig.386 Nos.385-6 for upper body form), broken but otherwise undamaged and definitely from a contemporary discard deposit. The later sixteenth century appears to be slimly represented – possibly a single rim sherd from a Dutch or Dutch-type probable cauldron in fine brown earthenware. From the earlier or mid seventeenth century quantities increase but, again, no material that is particularly noteworthy – just the fairly ubiquitous spread of red kitchen or pantry earthenwares, a few non-local or imported wares - Surrey-Hampshire Border ware, Frechen stoneware, English tin-glazed earthenware – and fragments from an earlier-mid eighteenth century Staffordshire white stoneware tea-pot and an Early Creamware plate is a taste of quality. The Late Post-Medieval material is similarly standard – a few sherds from earlier gilded English porcelains, Pearl Ware and Later Creamware bowls and plates and one or two transfer-printed white earthenwares.

E. Recommendations

1. None of the recovered material is intrinsically important enough to warrant future illustration or a separate pottery report.

F. Bibliography

Macpherson-Grant 1995 :

Macpherson-Grant, N (with Joy, J), ‘Late Medieval Pottery’, in Blockley, K, *et.al.*, *Excavations in the Marlowe Car Park and Surrounding Areas*, The Archaeology of Canterbury **V** (Part II) 1995, 898-908

Monaghan 1987:

Monaghan, J., *Upchurch and Thameside Roman Pottery*, BAR British Series **197** 1987

Webster 2005 :

Webster, P., *Roman Samian Pottery in Britain*, CBA Practical Handbook in Archaeology **13** (York) 2005

Analyst : N.Macpherson-Grant 17.5.2011

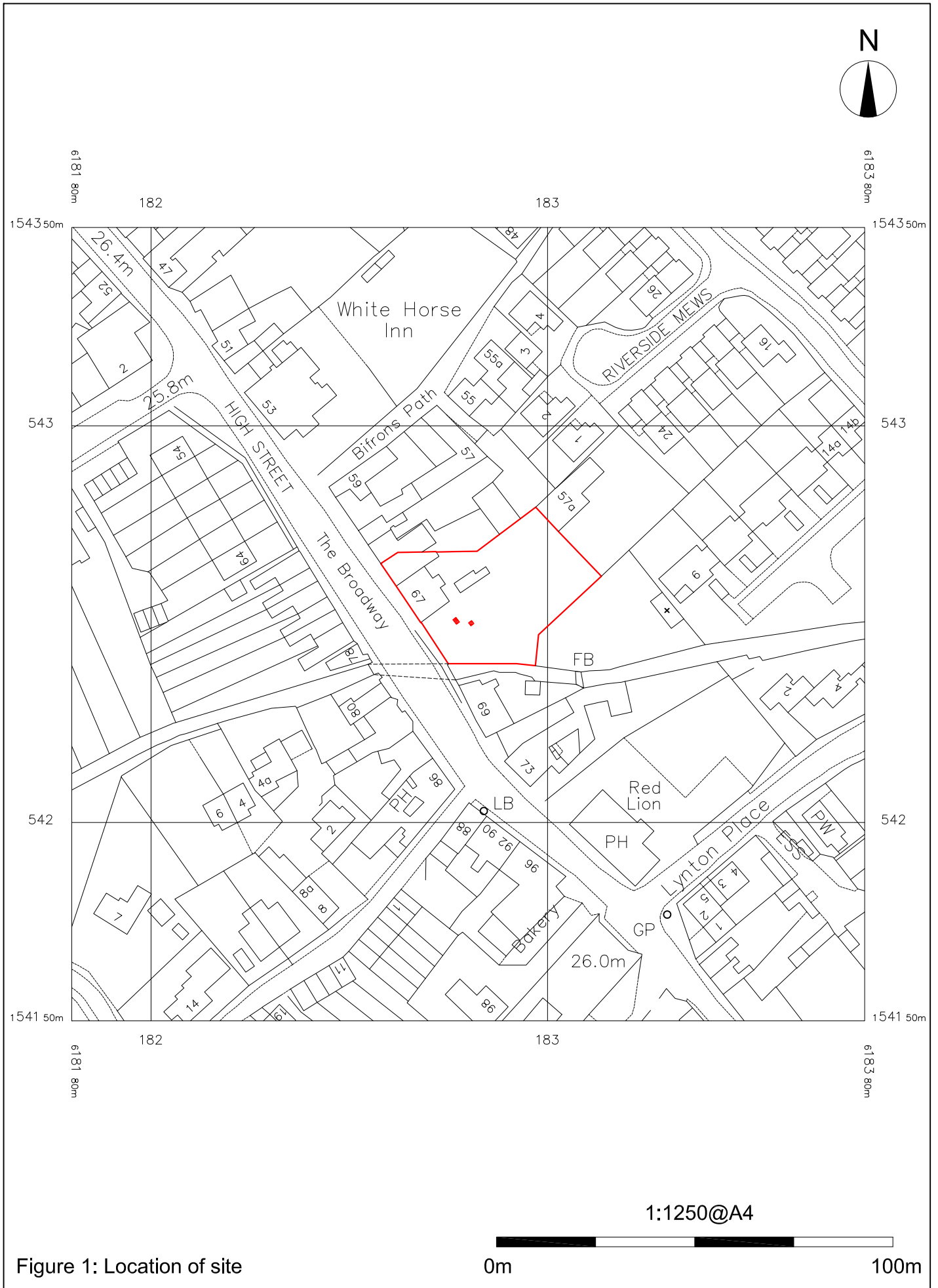

Figure 1: Location of site

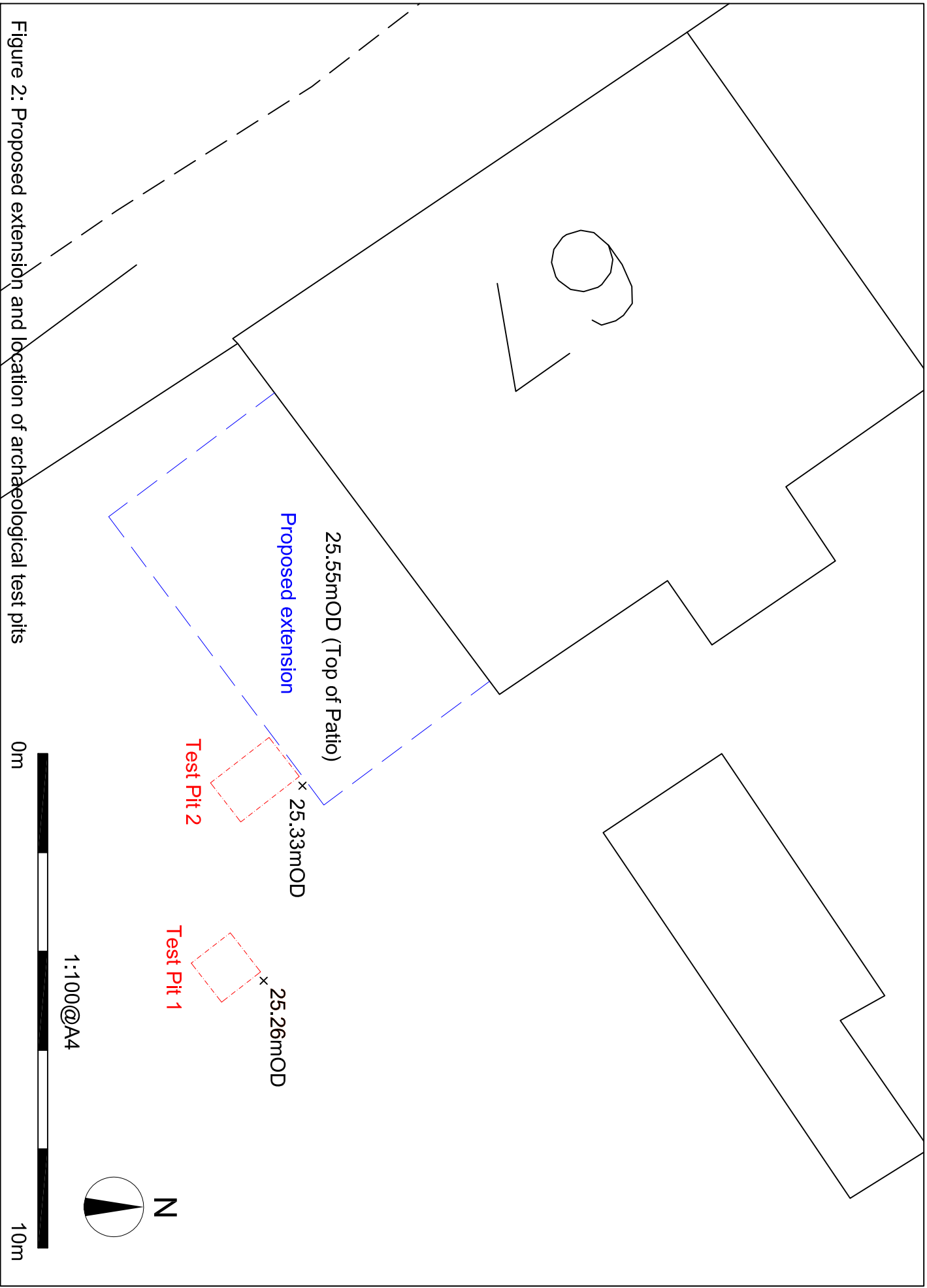
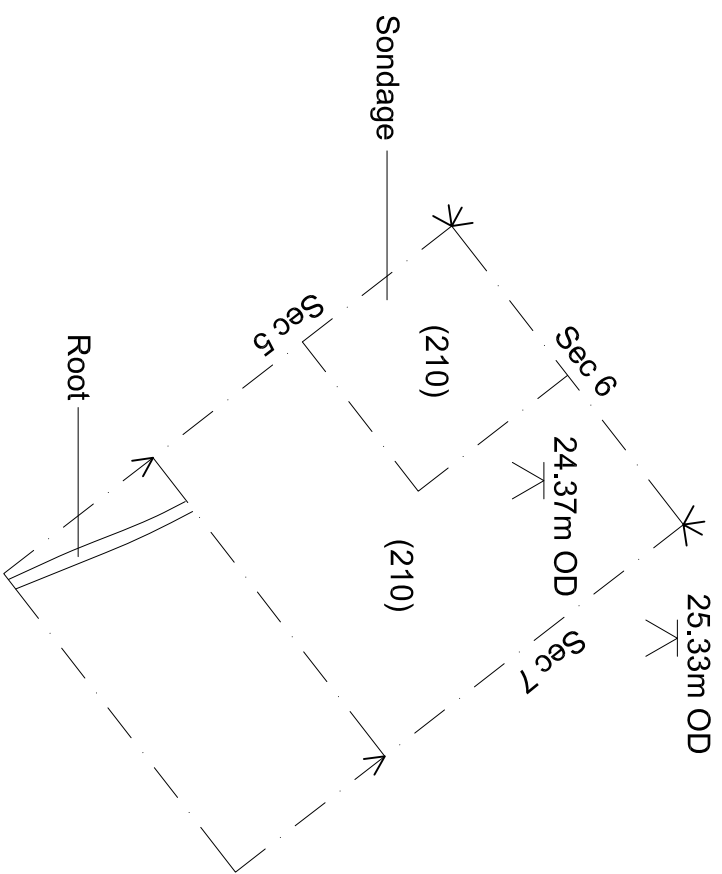

Figure 2: Proposed extension and location of archaeological test pits



618281.36mE
154252.80mN

Test Pit 2



618275.57mE
154248.58mN

Test Pit 1

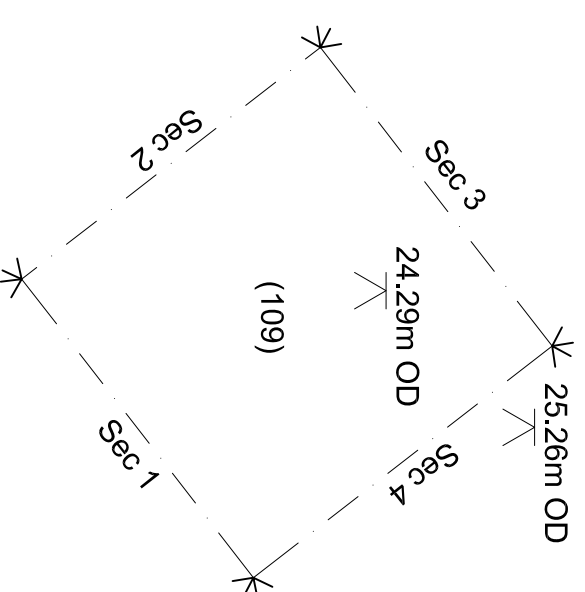

1:20@A3



Figure 3: Plan (Test Pit 1 and 2)

25.26mOD
X

NE

Section 1

SW SE

Section 2

NW

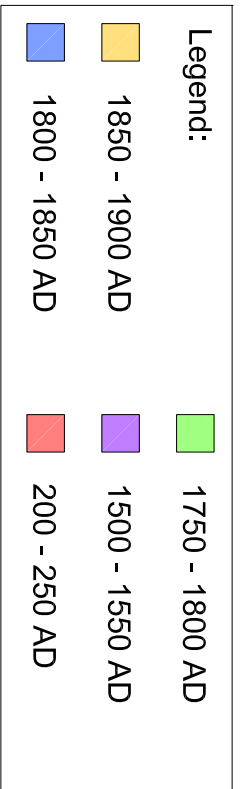
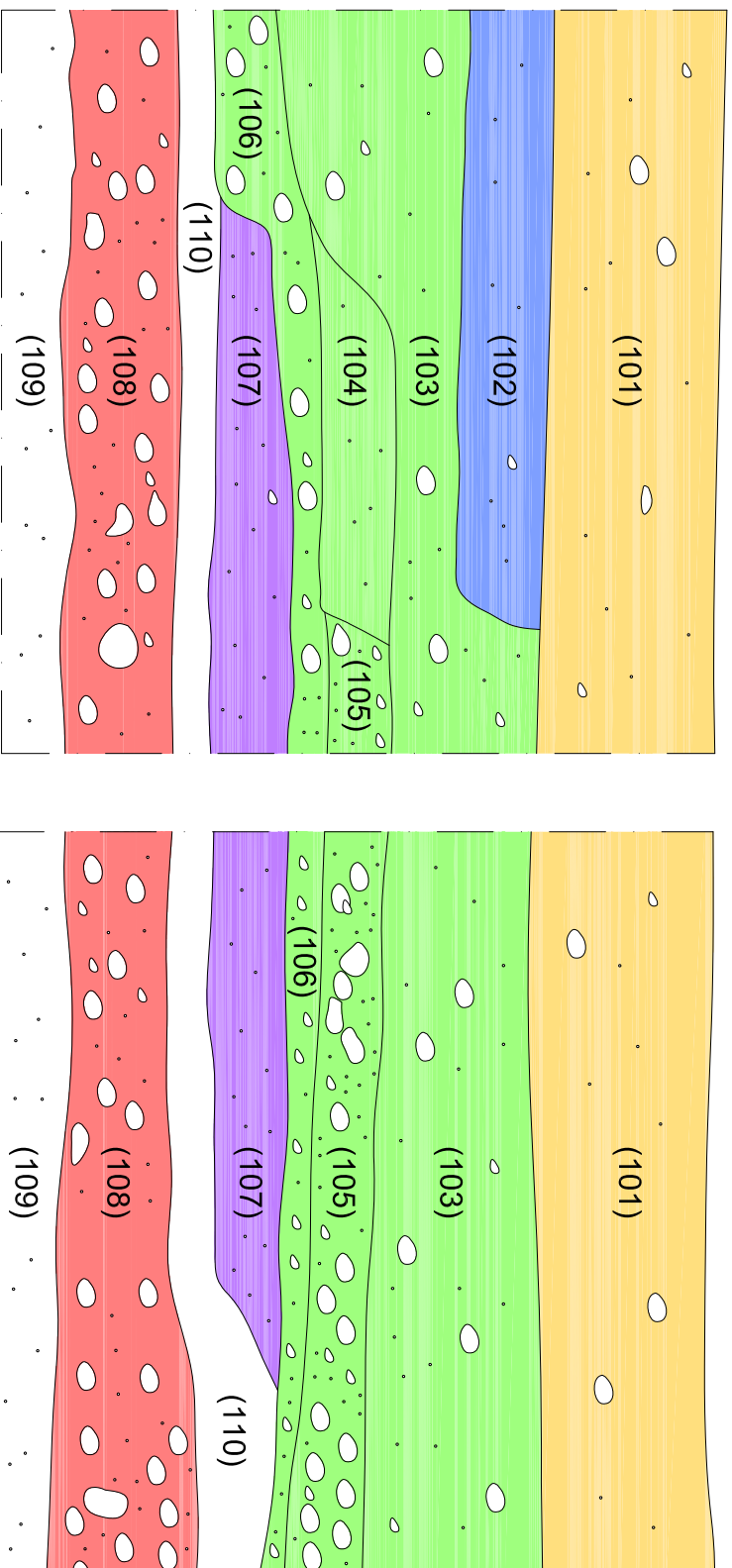

1:10@A4



Figure 4: Section 1 and 2 (Test Pit 1)

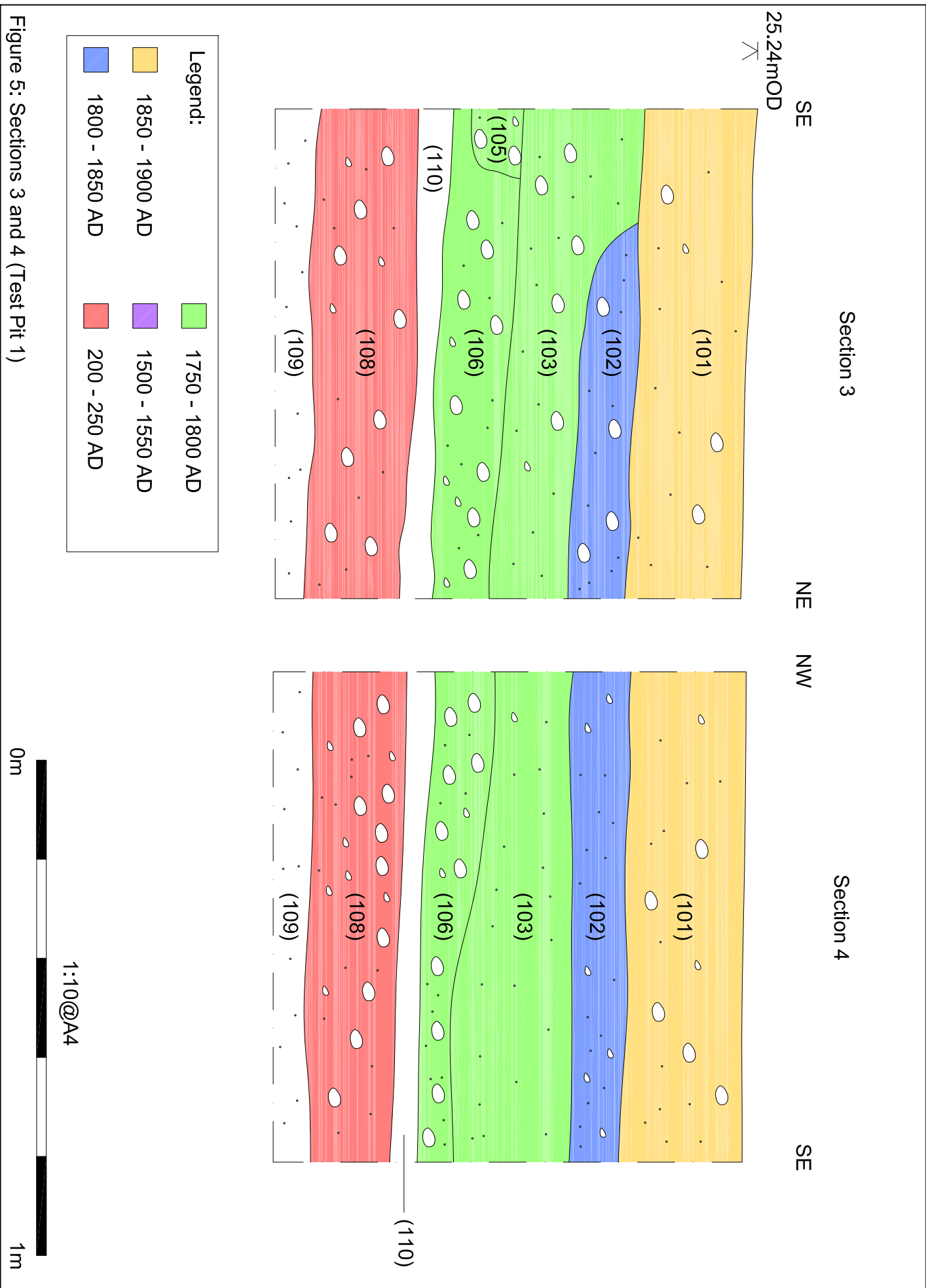

Figure 5: Sections 3 and 4 (Test Pit 1)

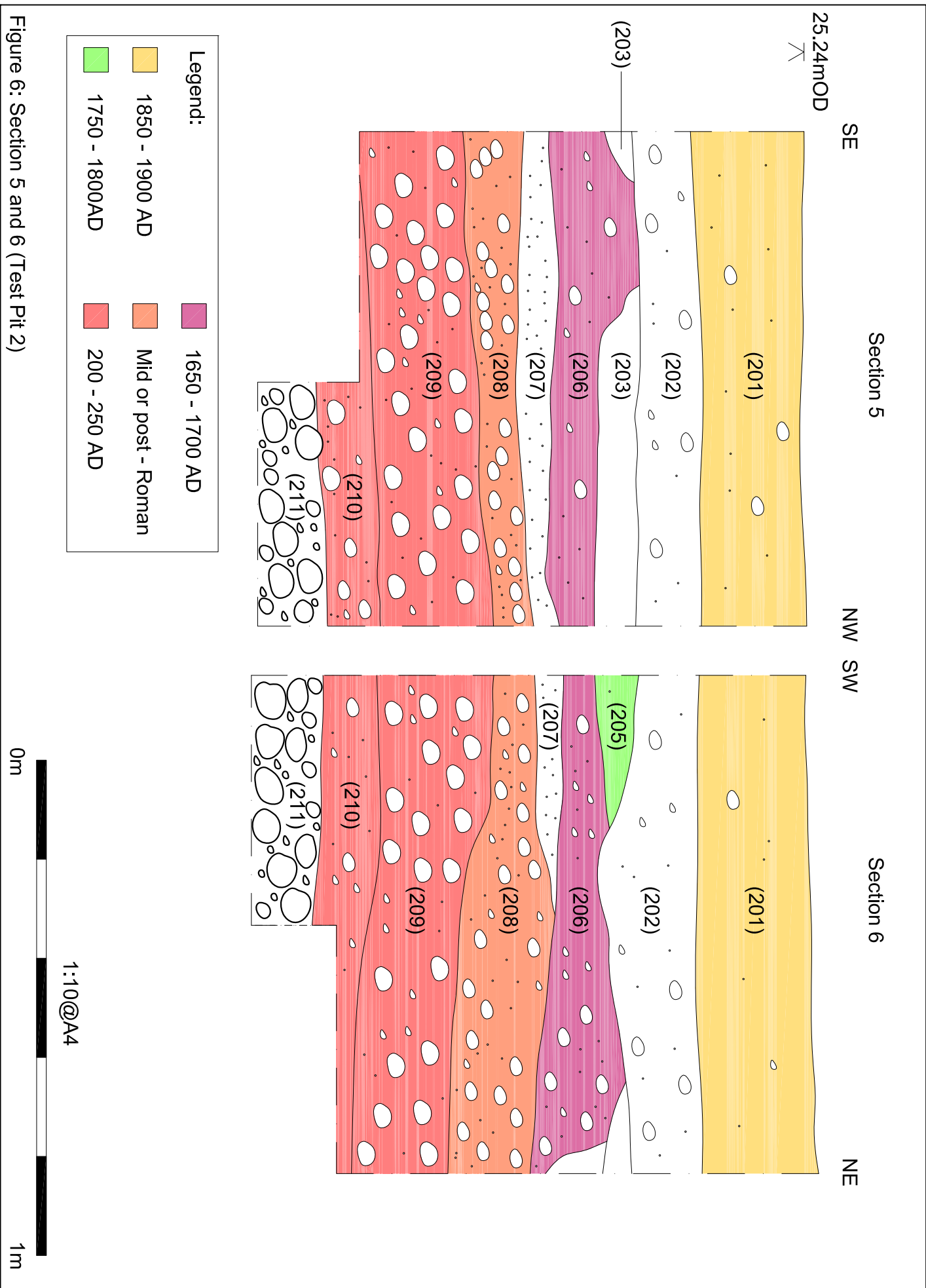

Figure 6: Section 5 and 6 (Test Pit 2)

25.27mOD
N



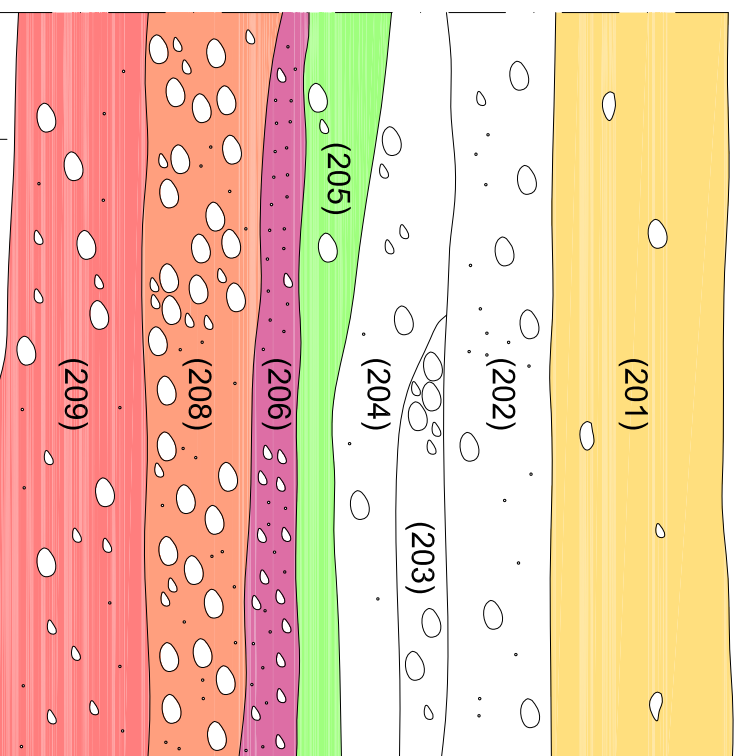

NW

Section 7

SE



Legend:

	1850 - 1900 AD		1650 - 1700 AD
	Mid or post - Roman		200 - 250 AD
	1750 - 1800AD		

1:10@A4



Figure 7: Section 7 (Test Pit 2)